



# Submittal Data Information

101-032

## Model 009 Cartridge Circulator

Effective: September 1, 2003

Supersedes: July 1, 2003

Job: \_\_\_\_\_ Engineer: \_\_\_\_\_ Contractor: \_\_\_\_\_ Rep: \_\_\_\_\_

| ITEM NO. | MODEL NO. | IMP. DIA. | G.P.M. | HEAD/FT. | H.P. | ELEC. CHAR. |
|----------|-----------|-----------|--------|----------|------|-------------|
|          |           |           |        |          |      |             |

### Features

- Standard High Capacity Output-Compact Design
- Quiet, Efficient Operation
- Direct Drive-Low Power Consumption
- Unique Replaceable Cartridge Design-Field Serviceable
- Self Lubricating
- No Mechanical Seal
- Unmatched Reliability-Maintenance Free
- Universal Flange to Flange Dimensions
- Cast Iron or Bronze Construction

### Materials of Construction

Casing (Volute): Cast Iron or Bronze  
 Stator Housing: Aluminum  
 Cartridge: Stainless Steel  
 Impeller: Non-Metallic  
 Shaft: Ceramic  
 Bearings: Carbon  
 O-Ring & Gaskets: EPDM

### Model Nomenclature

F – Cast Iron, Flanged  
 BF – Bronze, Flanged  
**Variations:**  
 Z – Zoning Circulator  
 J – Bronze Cartridge with Cast Iron Casing

### Performance Data

Flow Range: 0 – 8 GPM  
 Head Range: 0 – 34 Feet  
 Minimum Fluid Temperature: 40°F (4°C)  
 Maximum Fluid Temperature: 230°F (110°C)  
 Maximum Working Pressure: 125 psi  
 Connection Sizes: 3/4", 1", 1-1/4", 1-1/2" Flanged



**FOR INDOOR USE ONLY**

### Application

The Taco 009 is designed for a wide range of Residential and Light Commercial higher-head/lower-flow water circulating applications. Typical uses include Hydronic heating, Radiant In-Floor/Panel heating and closed-loop Solar heating systems. The Bronze 009 can be used in higher-head/lower-flow Heat Recovery, open-loop Solar heating and Light Commercial Domestic Water Recirculation systems. The unique replaceable cartridge contains all of the moving parts and allows for easy service, instead of replacing the entire circulator. Compact, direct-drive, low power consumption design is ideal for high-efficiency jobs.

### Pump Dimensions & Weights

|         |           | A   |     | B       |     | C      |    | D      |    | F     |     | G     |     | Ship Wt. |     |
|---------|-----------|-----|-----|---------|-----|--------|----|--------|----|-------|-----|-------|-----|----------|-----|
| Model   | Casing    | in. | mm  | in.     | mm  | in.    | mm | in.    | mm | in.   | mm  | in.   | mm  | lbs.     | Kg  |
| 009-F5  | Cast Iron | 7   | 178 | 5-11/16 | 144 | 3-3/16 | 81 | 3-5/16 | 84 | 4-1/8 | 105 | 6-3/8 | 162 | 9.5      | 4.3 |
| 009-BF5 | Bronze    | 7   | 178 | 5-11/16 | 144 | 3-3/16 | 81 | 3-5/16 | 84 | 4-1/8 | 105 | 6-3/8 | 162 | 9.5      | 4.3 |

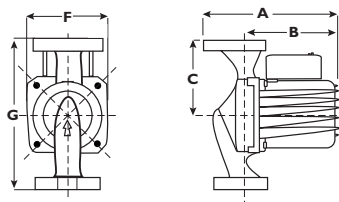

### Mounting Positions

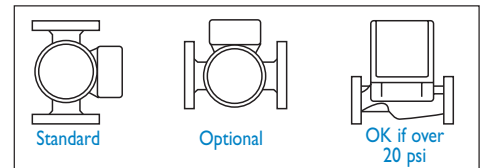

### Electrical Data

| Model                | Volts   | Hz | Ph | Amps | RPM  | HP  |
|----------------------|---|----|----|------|------|-----|
| 009-F5               | 115   | 60 | 1  | 1.40 | 3250 | 1/8 |
| 009-BF5              | 115   | 60 | 1  | 1.40 | 3250 | 1/8 |
| <b>Motor Type</b>    | Permanent Split Capacitor Impedance Protected |    |    |      |      |     |
| <b>Motor Options</b> | 220/50/1, 220/60/1, 230/60/1, 100/110/50/60/1 |    |    |      |      |     |

### Flange Orientation

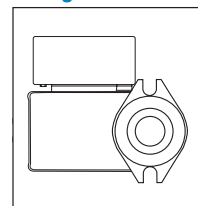

### Performance Field - 60Hz

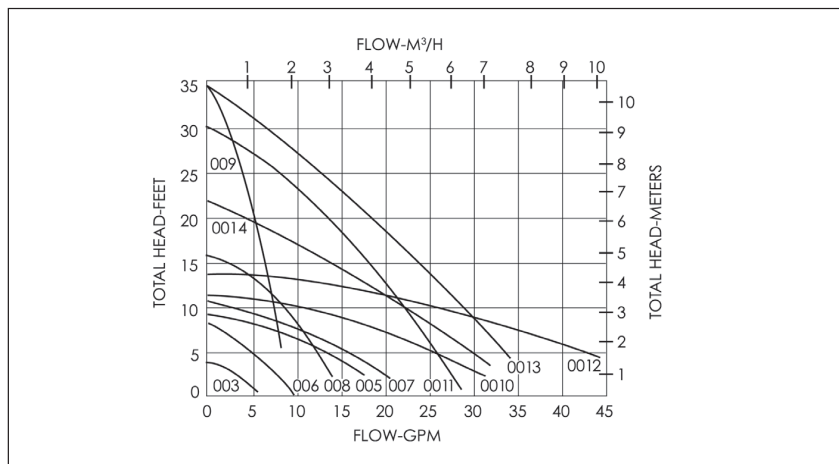

## Do it Once. Do it Right.

Taco, Inc., 1160 Cranston Street, Cranston, RI 02920 Telephone: (401) 942-8000 Fax: (401) 942-2360  
 Taco (Canada), Ltd., 6180 Ordan Drive, Mississauga, Ontario L5T 2B3 Telephone: (905) 564-9422 Fax: (905) 564-9436

Printed in USA  
 Copyright 2005  
 TACO, Inc.

Visit our website at: [www.taco-hvac.com](http://www.taco-hvac.com)